

SignageCMS Player

WISE-PaaS/SignageCMS



Features

- Bundled WISE-PaaS/SignageCMS Pro version
- Multiple players for different scenario applications
- Support offline playback by USB
- Support multi-screen displays and content cross-screen
- Provide Interactive APIs for application integration
- Support remote control by mobile phone APP

Introduction

Advantech interactive multimedia software WISE-PaaS/SignageCMS, provides the platform for editing and dispatching digital signage programs.

WISE-PaaS/SignageCMS allows users to manage and display dynamic, tailored messages which increases sales in real time.

Key Functions

Support Offline Playback by USB

Users can edit program on SignageCMS Server as well as save the schedule into USB, SignageCMS Player can support offline playback by USB

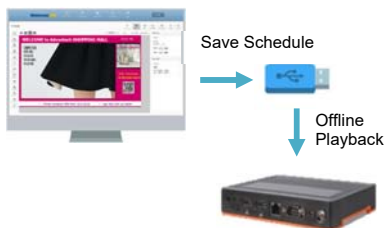

Provide Software Open APIs to trigger special content

Software Client can trigger any program which is in the schedule through RESTful API



Free Mobile App to switch the Program

There is a free mobile app "SignageCMS M" can be downloaded by google play or app store, the app can easy and fast to switch the program without server.



Specifications

		USM-110 series	DS-066 series	DS-082 series
Processor System	CPU	Arm® Cortex®-A17 quad-core processor (1.6 GHz)	Intel® Celeron® J1900 quad-core 2.0 GHz SoC processor	AMD V1605B/ R1606G
	System Chipset		Integrated in SOC	Integrated in SOC
	L2 Cache			
	BIOS		AMI uEFI 64-Mbit	AMI uEFI 128 Mbit
Memory	Technology		DDR3L 1333 MHz	DDR4 2400MHz
	Max. Capacity	2 GB onboard DDR3L (1333 MHz)	8 GB (up to 4 GB per SODIMM)	32GB (16GB per SO-DIMM)
Graphic & Display Tech.	Graphic Engine	Mali-T764, OpenGL ES 1.1/2.0/3.0, OpenCL 1.1, DirectX 11	Intel® HD Graphics	AMD Radeon HD graphics
	Graphic Memory			
	Resolution	HDMI1: Native 4K resolution up to 3840 x 2160 (default 1080p) HDMI2: 1920 x 1080	1920 x 1080 @ 60Hz	3840 x 2160 @ 60Hz
	Output	HDMI x 2	HDMI x 2	HDMI 2.0 x 4 (V1605B), HDMI 2.0 x 3 (R1606G)
	Multi Display	Up to 2 simultaneous outputs		
Video Format	Decoder: 4K 10-bits 60fps H.265, H.264, MPEG-1, MPEG-2, MPEG-4, VC-1, VP8, AVS, MVC Encoder: 1080P for H.264 (BP@level4.0, MP, HP@level4.0), MVC and VP8			
Storage	SATA / M.2		1 x 2.5-inch SATA III HDD/SSD (7 mm height)	2242 M Key
	Flash	16 GB of onboard eMMC		
	Extension	Micro SD		
Ethernet	Interface		Gigabit LAN Controller	Gigabit LAN Controller
	Controller		Intel I211-AT	Realtek RTL8111G
I/O Interface	LAN	1 x 10/100/1000 Mbps	1 x RJ45	1 x RJ45
	USB 2.0	4	3	2
	USB 3.0		1	2
	Audio	1	1 x Line-out, 1 x Mic in, supports Jack Sense	1 (SPDIF/Line-out/ Mic-in), support Jack Sense
	Serial	1 (RS232/485/422 by jumper)	1 x RS-232	1 x RS-232
Expansion	Mini PCIe	1 (for 4G module option)		
	M.2	1 (for Wi-Fi module option)		1 x 2230 E Key for wireless module
	PCIe x16 (Internal)			
	SIM slot (Internal)			
	MicroSD Card Slot	1		
Power Requirement	Power Consumption		Idle mode: 4.4 W (w/o expansion) Full mode: 13 W (w/o expansion)	
	Input Voltage	12V/3A	19 V DC-in (ATX/AT mode)	19 V DC-in (ATX/AT mode)
Watchdog Timer	Output		Interrupt, system reset	Interrupt, system reset
	Interval			255-level timer interval, setup by software
Physical Characteristics	Mounting	VESA (75 x 75), wall, desktop, pole, magnet, DIN rail	VESA/Desk/Wall/Din Rail	VESA/Desk/Wall/Din Rail
	Dimensions (W x H x D)	156 x 112 x 28 mm (6.14 x 4.41 x 1.10 in)	180 x 190 x 19 mm	180 x 190 x 19 mm
	Weight	0.43 kg (0.94 lb)	0.87 kg (1.92 lb)	0.87 kg (1.92 lb)
Environment	Operating Temperature	0 ~ 40° C (32 ~ 104° F)	0~40°C (w/HDD) @ 0.7 m/s air flow 0~50°C (w/SSD) @ 0.7m/s air flow	0 ~ 40° C (32 ~ 104F) with 0.7 m/s airflow
	Relative Humidity	90% @ 40° C (non-condensing)	95% @ 40° C (non-condensing)	95% @ 40° C (non-condensing), operating
Software Development Kit	Operating System	Android 6.0/Linux Debian 9.0 (Linux not support 4K)	Supports Win10 x64	Supports Win10 x64
	Signage Software	WISE-PaaS/SignageCMS	WISE-PaaS/SignageCMS	WISE-PaaS/SignageCMS
Certification	EMC	CCC/BSMI/FCC/UL/CB	CE, FCC Class B, CCC, BSMI	CE, FCC Class B, CCC, BSMI
	Safety	UL BSMI	UL, CB, CCC, BSMI	UL, CB, CCC, BSMI

Ordering Information

WISE-PaaS/SignageCMS Server Software/ Hardware with Software

P/N	Description	RAM	Storage	OS	SW
968SPUDSS0	SignageCMS Standard Server License	-	-	-	WISE-PaaS/SignageCMS Server Standard
968SPUDSS1	SignageCMS Pro Server License	-	-	-	WISE-PaaS/SignageCMS Server Pro
USM-260UDS1-G1E-C	USM-260_i5, RAM8G,HDD1TB,Win10,SigangeCMS server	8GB	1T_HDD	Win10	WISE-PaaS/SignageCMS Server Pro
AIMC-342UDS-G1E-C	AIMC-3420_i5, RAM8G,HDD1TB,WES7,SigangeCMS server	8GB	1T_HDD	Wes7	WISE-PaaS/SignageCMS Server Pro

WISE-PaaS/SignageCMS Client Hardware with Software

P/N	Description	RAM	Storage	OS	SW
USM-110UDS1-G1E-C	Arm® Cortex®-A17/2GB RAM /16G ROM / Android 6.0 2 Display Output : 2 x HDMI	2GB	16GB_Flash	Android6.0	WISE-PaaS/SignageCMS Client Pro
DS-066UDS1-B1E-C	J1900 2 Display Output : 2 x HDMI	-	-	-	WISE-PaaS/SignageCMS Client Pro
DS-066UDS1-G1E-C	J1900 / 4GB RAM / 500GB HDD / Win10 2 Display Output : 2 x HDMI	4GB	500GB_HDD	Win10	WISE-PaaS/SignageCMS Client Pro
DS-066UDS1-S1E-C	J1900 / 4GB RAM / 64G_SSD / Win10 2 Display Output : 2 x HDMI	4GB	64GB_SSD	Win10	WISE-PaaS/SignageCMS Client Pro
DS-082UDS1-B1E-C	AMD R1605B 4 Display Output : 4 x HDMI	-	-	-	WISE-PaaS/SignageCMS Client Pro
DS-082UDS1-S2E-C	AMD R1606G / 8G RAM / 128G SSD / Win10 / Fanless 3 Display Output : 3 x HDMI	8GB	128G_SSD	Win10	WISE-PaaS/SignageCMS Client Pro
DS-082UDS1-S4E-C	AMD R1605B / 8G RAM / 64G SSD / Win10 4 Display Output : 4 x HDMI	8GB	64GB_SSD	Win10	WISE-PaaS/SignageCMS Client Pro